

广东联升传导技术有限公司

UNIRISE ELECTRIC WIRE & CABLE CO., LTD.

(TEL): 0769-85554248

(FAX):0769- 85554753

Web Site: WWW.UNIRISE.CN

E-mail: technic@unirise.cn

SPECIFICATION FOR APPROVAL

承认书

CUSTOMER(客户) :	超擎数智
CUSTOMER P/N(客户料号/图号):	美规13A+C13
UNIRISE P/N(联升图号):	C036-009-2025
PRODUCT NAME(品名):	UE-321+UE-313 SJT 3X16AWG 105℃电源线
DATE(日期):	2025-9-25

制 造 商 MANUFACTURER	广东联升传导技术有限公司 UNIRISE ELECTRIC WIRE & CABLE CO., LTD.	
制 作 MADE BY	审 核 CHECKED BY	核 准 APPROVED BY
王隆花	张永华	宋瑜

客 户 CUSTOMER		
签名/盖章 Signature/Stamp	检 查 CHECKED BY	核 准 APPROVED BY
<input type="checkbox"/> 认可 ACCEPTED	<input type="checkbox"/> 未认可 UNACCEPTED	<input type="checkbox"/> 其它 OTHER

请贵公司于完成此份产品规格书及样品的承认后, 签回此封面给本公司做为依据, 以符合 ISO 9001 的规定, 但如果无法签回时, 本公司将依据贵公司所下此规格的第一张订单, 做为已获得贵公司承认的依据。

Please confirm and return this confirmation to us, for complying ISO 9001. However, the specification will sequentially be recognized and executed by us according to your first p/o, if this confirmation is unable to be confirmed and returned to us in time.

版本	变更描述	日期	确认人
V1.0	初版发行	2025-9-25	覃献芬

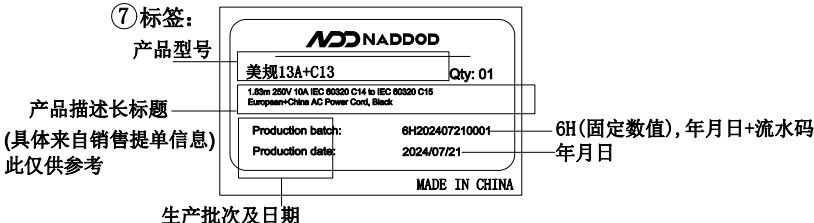
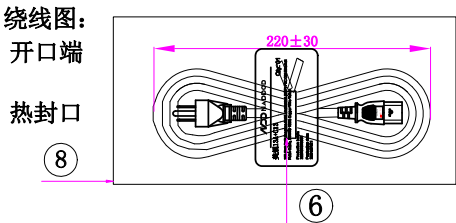
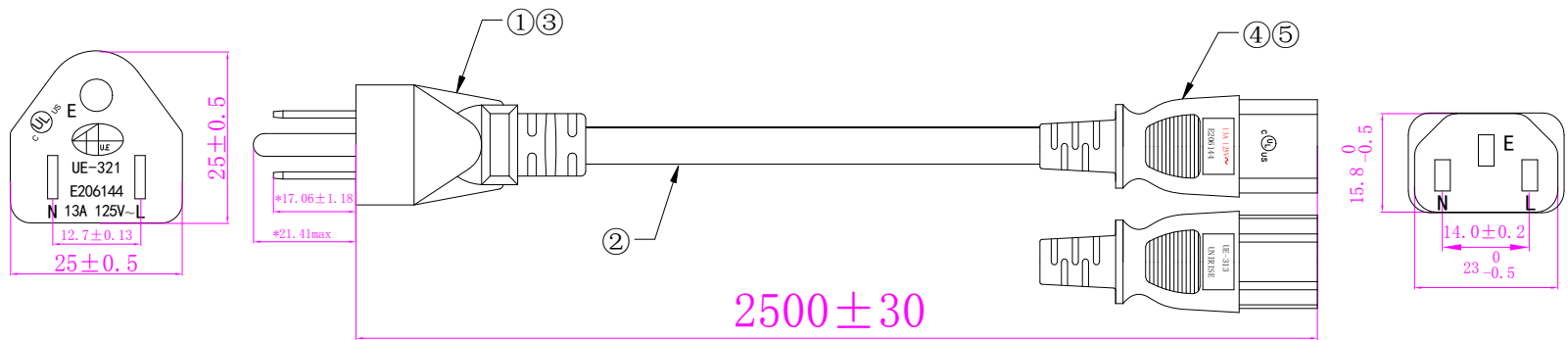

管控要点:

- 插头: a. UE-321, 电流(A):13, 电压(V):125, 认证: UL
b. UE-313(C13), 电流(A):13, 电压(V):125,, 认证: UL
- 电线:SJT 3G16AWG 105℃ unirise 凹字 黑色 认证: UL
- 高压测试: 1500V/S 无击穿, 无闪烁
- 电源线符合ROHS环保要求
- 头部零、火线端子焊锡饱满平滑、无毛刺

序号	物料号码	材料描述	数量
8	39110009	PE袋 0.03X120X300mm 一短边开口另一端封口	1PCS
7	39005227	空白标签 55X45mm 合成纸 白色 (宏山)	1PCS
6	LK0715	PE扎带 L=150mm 黑色	1PCS
5	316313903	一体式品字尾内架 PBT 白色	1PCS
4	BK116000	插头胶料60P PVC UE-313 黑色	/
3	BK113800	插头胶料38P PVC UE-321 黑色	/
2	CK91216322	UL SJT 3X16AWG 105℃ 黑色	1PCS
1	315321901	UE-321 一体式端子 黄铜镀镍 白色	1PCS

印字内容:

E176096 (UL) SJT VW-1 105℃ 300V 3×1.31mm² (16AWG) Or
C(UL) SJT FT1 105℃ 300V 3×1.31mm² (16AWG) UNIRISE

适应产品	交换机	样品图号	C036-007-2025	版本	V1.0
客户料号	美规13A+C13	客户名称	武汉超擎数智科技	单位	mm
客户图号		制作依据	样品要求表	比例	
日期	制图	审核	批准	UNIRISE	
2025-9-25	覃献芬	颜家乐	宋瑜	ELECTRIC WIRE & CABLE CO.,LTD	

版次	变更内容	确 认	日 期
A/0	首次发行	宋 瑜	2018/10/04

注意：带*号的标注尺寸为关键尺寸

印字情况：多种电流： 10A 13A 15A
电压： 125V

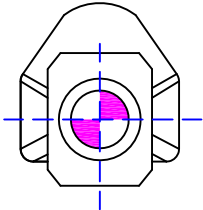
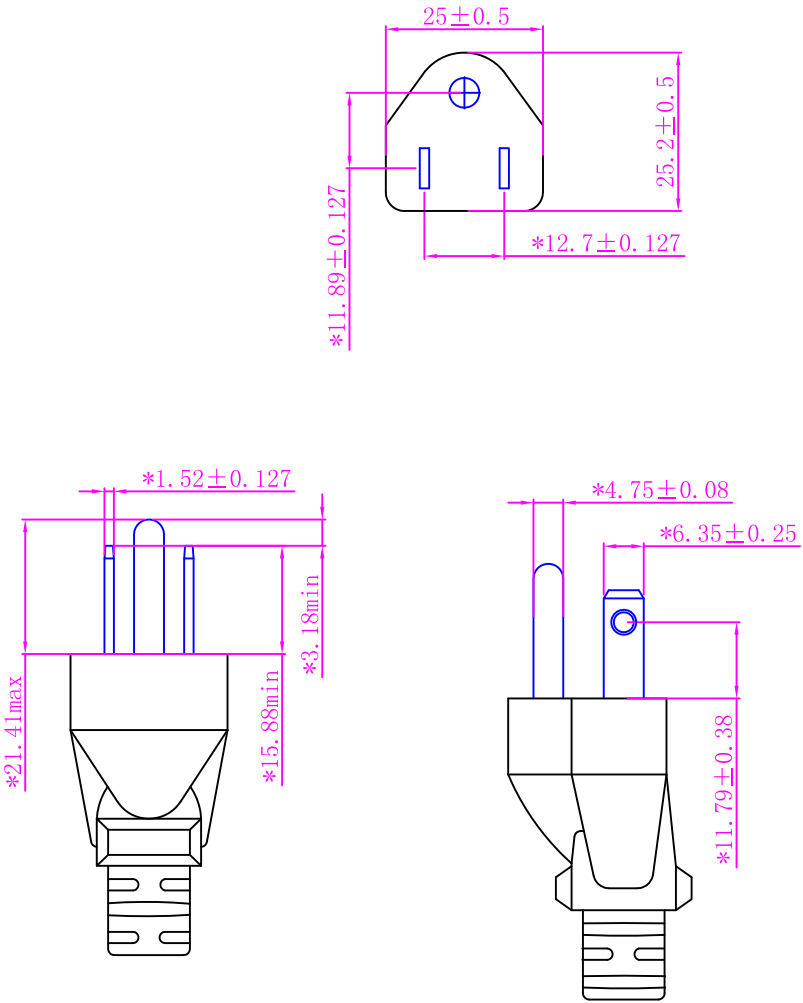
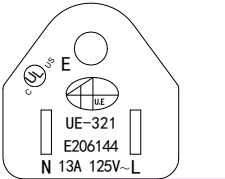

产品尺寸及标示图		核 准	刘英琦	公差： 0 ~ 2=±0.1 2 ~ 10=±0.2 10~20=±0.3 20~40=±1.5 40~60=±2.0 角度公差:1°			
广东联升传导技术有限公司 Unirise Electric Wire & Cable CO.,LTD		审 核	宋瑜				
		制 图	黄祥				
图 号	PD-042	日 期	2018. 10. 04				
产品型号	UE-321	视 图		比例	1: 1	单位	mm
		材 质	PVC	REV:	A/0		

版次	变更内容	确 认	日 期
A/0	首次发行	宋 瑜	2018/09/12
A/1	新增CCC、ENEC、SAA、VDE、KC字板整合	宋 瑜	2020/07/21

注意：带*号的标注尺寸为关键尺寸

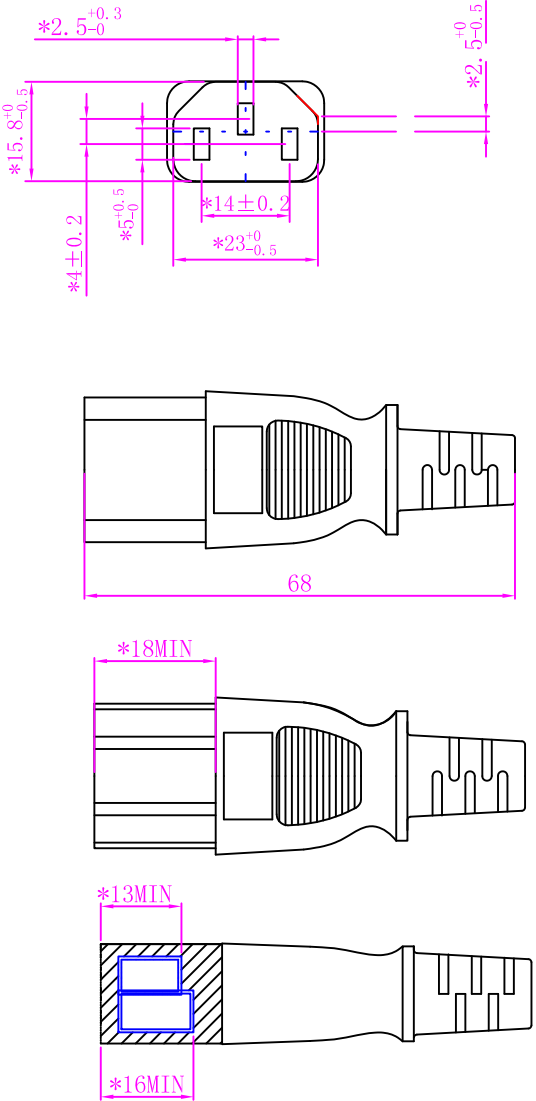

印字情况:

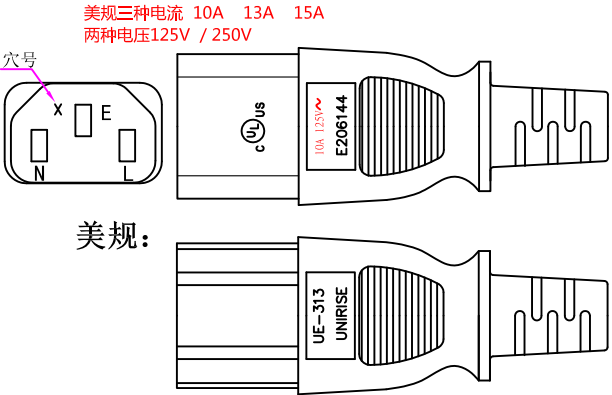

产 品 尺 寸 及 标 示 图		核 准	刘英琦	公差: 0 ~ 2=±0.1 2 ~10=±0.2 10~20=±0.3 20~40=±1.5 40~60=±2.0 角度公差:1°			
广东联升传导技术有限公司 Unirise Electric Wire & Cable CO.,LTD		审 核	宋瑜				
		制 图	黄祥				
图 号	PD-022	日 期	2020. 07. 21				
产品型号	UE-313	视 图		比例	1: 1	单位	mm
				材质	PVC	REV: A/1	

广东联升传导技术有限公司
UNIRISE ELECTRIC WIRE &CABLE CO., LTD.
SPECIFICATION (规格书)

PAGE:1 of 2

STYLE(品名)	SJT 16AWGX 3C 105℃	STANDARD(标准)	UL62 UL1581
PART NO.(物料编号)	CX91216322	RATING(等级)	300V, 105℃
APPLICATION: USED IN HOUSEHOLD CLOCKS.FANS.RADIOS AND SIMILAR APPLIANCES.			
constructional checking (结构检查)			
CONDUCTOR(导体)	SIZE (规格)	16AWGX3C	
	MATERIAL(材质)	裸铜绞线 AS	
	CONSTRUCTION (结构)	26/0.25±0.008mm	
	CONDUCTOR RESISTANCE (导体电阻)	≤14.1 Ω /KM (温度 20℃时)	
INSULATION(绝缘)	AVG.THICHNESS (平均厚度) (mm)	0.76mm	
	MIN.THICHNESS (最小厚度) (mm)	0.69mm	
	OVER DIAMETER (完成外径) (mm)	3.1±0.2mm	
	MATERIAL(材质)	PVC	
	COLOR (颜色)	黑 BLACK、白 WHITE、绿 GREEN	
JACKET(外被)	AVG.THICHNESS (平均厚度) (mm)	0.76mm	
	MIN.THICHNESS (最小厚度) (mm)	0.61mm	
	MATERIAL(材质)	PVC	
	OVER DIAMETER (完成外径) (mm)	8.25±0.3mm	
	COLOR (颜色)	Any color 任一颜色	
Physical performance test (物理性能测试):			
INSULATION 绝缘物理性能	UNAGED 老化前	TENSILE STRENGTH (抗张强度) N/mm ²	≥10.3
		ELONGATION (伸长率) %	≥100
	AGED 老化后	Deviation between ageing (MAX) 老化前后伸长率残率 额定温度 105℃ 136±2℃×168h %	≥85
		Deviation between ageing 老化前后抗张残率 %	≥65
JACKET 外被物理性能	UNAGED 老化前	TENSILE STRENGTH (抗张强度) N/mm ²	≥10.3
		ELONGATION (伸长率) %	≥100
	AGED 老化后	TENSILE STRENGTH (抗张强度) N/mm ²	≥85
		ELONGATION (伸长率) %	≥45
DIFFERENCE BETWEEN AGEING 变化率		TENSILE STRENGTH (抗张强度) %	-----
		ELONGATION (伸长率) %	-----

广东联升传导技术有限公司

UNIRISE ELECTRIC WIRE & CABLE CO., LTD.

SPECIFICATION (规格书)

PAGE:2 of 2

Electrical tests (电气性能测试):		
INSULATION RESISTANCE (绝缘电阻)	≥0.762MΩ.KM in water At 15℃	
VOLTAGE TEST (耐压试验) CABLE	2.0 KV/1min 无击穿	
Rating Temp (温度等级)	105℃	
Rating Volt (额定电压)	300V	
SPARK TEST (火花测试)	6KV	
Other performance test (其它性能测试):		
VISUAL INSPECTION(外观检查)	-----	
Durability of printing (颜色和标志耐久性试验)	-----	
Mechanical Strength Test (机械强度试验)	18AWG 吊重 150Lbs 保持一分钟，不断裂，16AWG 免做此试验	
Flame test (耐燃试验) VW-1	OK	
Tightness of insulation test (绝缘紧固测试)	位移≤3.2mm (G=8Lbs, T=30S, L=40+305+75mm)	
Bending test at low temperature Cable or core(低温弯曲)	-20℃±1℃×4H 不开裂	
Deformation test (加热变形)	121±1℃x1H; 压 300g 重物，变形小于 50%	
Hest shock test (热冲击试验)	121±1℃x1H 不开裂	
MARKING(印字): 凹印字		
E176096 (UL) SJT VW-1 105℃ 300V 3x1.31mm ² (16AWG)		
Or C(UL) SJT FT1 105℃ 300V 3x1.31mm ² (16AWG) UNIRISE		
CONSTRUCTION (结构图示):		
<div></div>		
APPROVED BY(批准): 刘英琦	CHECKED BY (审核): 宋瑜	MADE BY (制定): 成协伟



FOLLOW-UP SERVICE PROCEDURE
(TYPE L)

FLEXIBLE CORD
(ZJCZ, ZJCZ7)

Manufacturer: SEE ADDENDUM FOR MANUFACTURER LOCATIONS

Applicant: 354263 (Party Site)
(714326-001) UNIRISE ELECTRIC WIRE & CABLE CO LTD
LOONGYAN INDUSTRIAL AREA
HUMEN
DONGGUAN
GUANGDONG 523920 CHINA

Listee: 354263 (Party Site)
(714326-001) SAME AS APPLICANT

This Follow-Up Service Procedure authorizes the above Manufacturer(s) to use the marking specified by UL LLC, or any authorized licensee of UL LLC, including the UL Contracting Party, only on products when constructed, tested and found to be in compliance with the requirements of this Follow-Up Service Procedure and in accordance with the terms of the applicable service agreement with UL Contracting Party. The UL Contracting Party for Follow-Up Services is listed on addendum to this Follow-Up Service Procedure ("UL Contracting Party"). UL Contracting Party and UL LLC are referred to jointly herein as "UL."

UL further defines responsibilities, duties and requirements for both Manufacturers and UL representatives in the document titled, "UL Mark Surveillance Requirements" that can be located at the following web-site: <http://www.ul.com/fus>. Manufacturers without Internet access may obtain the current version of this document from their local UL customer service representative or UL field representative. For assistance, or to obtain a paper copy of this document or the Follow-Up Service Terms referenced below, please contact UL's Customer Service at <http://www.ul.com/aboutul/locations/>, select a location and enter your request, or call the number listed for that location.

The Applicant, the specified Manufacturer(s) and any Listee/Classified Co. in this Follow-Up Service Procedure must agree to receive Follow-Up Services from UL Contracting Party. If your applicable service agreement is a Global Services Agreement ("GSA"), the Applicant, the specified Manufacturer(s) and any Listee/Classified Co. will be bound to a Service Agreement for Follow-Up Services upon the earliest by any Subscriber of use of the prescribed UL Mark, acceptance of the factory inspection, or payment of the Follow-Up Service fees which will incorporate such GSA, this Follow-Up Service Procedure and the Follow-Up Service Terms which can be accessed by clicking here: <http://services.ul.com/fus-service-terms>. In all other events, Follow-Up Services will be governed by and incorporate the terms of your applicable service agreement and this Follow-Up Service Procedure.

It is the responsibility of the Listee/Classified Co. to make sure that only the products meeting the aforementioned requirements bear the authorized Marks of UL LLC, or any authorized licensee of UL LLC.

This Follow-Up Service Procedure contains information for the use of the above Manufacturer(s) and representatives of UL and is not to be used for any other purpose. It is provided to the Manufacturer with the understanding that it will be returned upon request and is not to be copied in whole or in part.

This Follow-Up Service Procedure, and any subsequent revisions, is the property of UL and is not transferable. This Follow-Up Service Procedure contains confidential information for use only by the above named Manufacturer(s) and representatives of UL and is not to be used for any other purpose. It is provided to the Subscribers with the understanding that it is not to be copied, either wholly or in part unless specifically allowed, and that it will be returned to UL upon request.

Capitalized terms used but not defined herein have the meanings set forth in the GSA and the applicable Service Terms or any other applicable UL service agreement.

UL shall not incur any obligation or liability for any loss, expense or damages, including incidental, consequential or punitive damages arising out of or in connection with the use or reliance upon this Follow-Up Service Procedure to anyone other than the above Manufacturer(s) as provided in the agreement between UL LLC or an authorized licensee of UL LLC, including UL Contracting Party, and the Manufacturer(s).

UL LLC has signed below solely in its capacity as the accredited entity to indicate that this Follow-Up Service Procedure is in compliance with the accreditation requirements.

Bruce A. Mahrenholz
Director
Conformity Assessment Programs (CPO)
UL LLC

国擎数智科技有限公司存档使用，不作其他用途。

INDEX

Construction	United States Type	Canadian Type	Section
PVC Parallel Cords:	SPT-1, SPT-2, SPT-3, NISPT-1, NISPT-2	SPT-1, SPT-2, SPT-3, NISPT-1, NISPT-2	1
PVC Jacketed Cords	SVT, SJT, SJTW, ST, STW	SVT, SJT, SJTW, ST, STW	2
Withdrawn			3
Decorative Cords:	XTW, CXTW, SPT-1W, SPT-2W	SPT-1W, SPT-2W	4
Heater Cords	HPN	HPN	5
Parallel Cords with -R suffix: Thermoplastic	SPT-2-R SPT-2W-R	N/A	6
PVC Jacketed Cords With R Suffix	SVT-R SJT-R, SJTW-R	N/A	7
* TPE Parallel Cords:	SPE-1, SPE-2, SPE-3, NISPE-1, NISPE-2	SPE-1, SPE-2, SPE-3, NISPE-1, NISPE-2	8
Heater Cords With -R Suffix:	HPN-R	N/A	9
TPE Jacketed Cords	SVE, SJE	SVE, SJE	10
Tinsel Cords:	TPT	TPT	11
PVC Parallel Cord with Fibrous Braid:	SPT-2-B	SPT-2-B	12
Jacketed Cords: Thermoplastic with Fibrous Braid	SVT-B, SJT-B	SVT-B, SJT-B	13
TPE Parallel Cord with Fibrous Braid:	SPE-2-B	SPE-2-B	14
Jacketed Cords: Thermoset	SV, SVO, SVOO, SJ, SJO, SJOO, SJOW, SJOOW, S, SO, SOO, SOW, SOOW	SV, SVO, SVOO, SJ, SJO, SJOO, SJOW, SJOOW, S, SO, SOO, SOW, SOOW	15
Jacketed Heater Cords	HSJ, HSJW, HSJO, HSJOW, HSJOO, HSJOOW	HSJ, HSJW, HSJO, HSJOW, HSJOO, HSJOOW	16
Jacketed Cords: Thermoplastic with Fibrous Braid	SVE-B	SVE-B	17

N/A - Not Applicable.



File E206144

Vol 1

Auth. Page 1

Issued: 2000-01-13

Revised: 2019-06-04

FOLLOW-UP SERVICE PROCEDURE
(TYPE L)

CORD SETS AND POWER-SUPPLY CORDS
(ELBZ,ELBZ7)

Manufacturer: SEE ADDENDUM FOR MANUFACTURER LOCATIONS

Applicant: 354263 (Party Site)
(714326-001) UNIRISE ELECTRIC WIRE & CABLE CO LTD
LOONGYAN INDUSTRIAL AREA
HUMEN
DONGGUAN
GUANGDONG 523920 CHINA

Listee: 354263 (Party Site)
(714326-001) SAME AS APPLICANT

Use of the Mark

This Follow-Up Service Procedure authorizes the above Manufacturer(s) to use the marking specified by UL LLC, or any authorized licensee of UL LLC, including the UL Contracting Party, only on products when constructed, tested and found to be in compliance with the requirements of this Follow-Up Service Procedure and in accordance with the terms of the applicable service agreement with UL Contracting Party. The UL Contracting Party for Follow-Up Services is listed in the addendum to this Follow-Up Service Procedure ("UL Contracting Party"). UL Contracting Party and UL LLC are referred to jointly herein as "UL."

It is the responsibility of the Applicant, Manufacturer(s), and Listee/Classified Co. to make sure that only the products meeting the aforementioned requirements bear the authorized Marks of UL LLC, or any authorized licensee of UL LLC.

广东联升传导技术有限公司仅供内部档案使用，不作其他用途。

Additional Responsibilities

Additional responsibilities, duties and requirements for the Applicant and Manufacturers are defined under Additional Resources at the following web-site: <http://www.ul.com/fus> . Manufacturers without Internet access may obtain the current version of these documents from their local UL customer service representative or UL field representative. For assistance, or to obtain a paper copy of these documents or the Follow-Up Service Terms referenced below, please contact UL's Customer Service at <http://www.ul.com/aboutul/locations/> , select a location and enter your request, or call the number listed for that location.

Acceptance of Follow-Up Services

The Applicant and the specified Manufacturer(s) and any Listee/Classified Co. in this Follow-Up Service Procedure must agree to receive Follow-Up Services from UL Contracting Party. If your applicable service agreement is a Global Services Agreement ("GSA"), the Applicant, the specified Manufacturer(s) and any Listee/Classified Co. will be bound to a Service Agreement for Follow-Up Services upon the earliest by any Subscriber of a) use of the prescribed UL Mark, b) acceptance of the factory inspection, or c) payment of the Follow-Up Service fees. The Service Agreement incorporates such GSA, this Follow-Up Service Procedure and the Follow-Up Service Terms which can be accessed by clicking the following link: <http://services.ul.com/fus-service-terms> . In all other events, Follow-Up Services will be governed by and incorporate the terms of your applicable service agreement and this Follow-Up Service Procedure.

Use and Ownership of the Follow-Up Service Procedure

This Follow-Up Service Procedure, and any subsequent revisions, is the property of UL and is not transferable. This Follow-Up Service Procedure contains confidential information for use only by the Applicant, the specified Manufacturer(s), and representatives of UL and is not to be used for any other purpose. It is provided to the Subscribers with the understanding that it is not to be copied, either wholly or in part unless specifically allowed, and that it will be returned to UL, upon request.

Definition of Terms

Capitalized terms used but not defined herein have the meanings set forth in the GSA and the applicable Service Terms or any other applicable UL service agreement.

No Third Party Liability

UL shall not incur any obligation or liability for any loss, expense or damages, including incidental, consequential or punitive damages arising out of or in connection with the use or reliance upon this Follow-Up Service Procedure to anyone other than the above Manufacturer(s) as provided in the agreement between UL LLC or an authorized licensee of UL LLC, including UL Contracting Party, and the Manufacturer(s).

Certification Body

UL LLC has signed below solely in its capacity as the certification body to indicate that this Follow-Up Service Procedure fulfills the requirements for certification documentation issued by the certification body.

Bruce A. Mahrenholz
Director
Conformity Assessment Programs (CPO)
UL LLC

PRODUCT COVERED:

* USU, CNU - Unlisted **Component - Attachment Plug**, Cat. Nos. UE-221, UE-222, UE-321, UE-222A, UE-321B, UE-327, UE-322, UE-220, UE-320, UE-322A, UE-254, UE-255, UE-251, UE-374, UE-267, UE-381B, UE-299, UE-6002, UE-413 and **UE-410 wired with Flexible Cord without an "-R" suffix.**

USU - Unlisted Component - Attachment Plug, Cat. Nos. UE-221, UE-222, UE-222A, UE-321, UE-321B, UE-327, UE-322, UE-254, UE-299 and **UE-410 wired with Flexible Cord** with an "-R" suffix.

ELECTRICAL RATING:

Config .	Cat. No.	USU	CNU	Cord AWG	Cord Type (Group)	Current (Amps)	Outdoor Use (Y/N)
1-15P	UE-221	X	X	18	SPE-1	10	N
		X	X	18	SPE-2	10	N
		X	X	18	SPT-1	10	N
		X	X	18	SPT-1W	10	N
		X	X	18	NISPT-1	10	N
		X	X	18, 16	SPT-2	10, 13	N
		X	-	18, 16	SPT-2-R	10, 13	N
		X	X	18, 16	Cat. No. UEB001	10, 13	N
		X	X	18, 16	SPT-2W	10, 13	N
		X	X	18, 16	NISPT-2	10, 13	N
		X	X	18, 16, 14	HPN	10, 15, 15	N
		X	-	18, 16, 14	HPN-R	10, 15, 15	N
		X	X	18, 16	SPT-2-B	10, 13	N
		X	X	18, 16 18, 16 14 18	SVT (5) SJT (3) SJT (3) SVT-B	10, 13 10, 13 15 10	N
		X	X	16	STW	13	N
		X	-	18 18, 16	SVT-R SJT-R	10 10, 13	N
1-15P	UE-222A	X	X	18	SVT (5), SJT (3)	10	N
		X	-	18	SVT-R, SJT-R	10	N
		X	X	17	SVT (5)	12	N
		X	X	16	SVT (5), SJT (3)	13	N
		X	-	16	SVT-R, SJT-R	13	N
		X	X	14	SJT (3)	15	N

ELECTRICAL RATING: (CONT'D)

Config	Cat. No.	USU	CNU	Cord AWG	Cord Type (Group)	Current (Amps)	Outdoor Use (Y/N)
5-15P	UE-321	X	X	18, 16	SVT (5)	10, 13	N
				18	SVT-B	10	
				18, 16, 14	SJT (3)	10, 13, 15	
				18, 16, 14	HPN	10, 15, 15	
				18, 16	SPT-2	10, 13	
		X	X	16	STW	13	N
		X	-	18, 16	SVT-R	10, 13	N
				18, 16, 14	SJT-R	10, 13, 15	
				18, 16, 14	HPN-R	10, 15, 15	
				18, 16	SPT-2W	10, 13	
		X	X	18, 16	SPT-2-R	10, 13	N
				18, 16	HSJO, HSJOW	10, 15	

武汉超擎数智科技有限公司仅供武汉超擎数智科技有限公司存档使用，不作其他用途。

ELECTRICAL RATING: (CONT'D)

Config	Cat. No.	USU	CNU	Cord AWG	Cord Type (Group)	Current (Amps)	Outdoor Use (Y/N)
5-15P	UE-321B	X	X	18	HPN, SVT(5), SJT(3)	10	N
		X	-	18	HPN-R, SVT-R, SJT-R	10	N
		X	X	17	SVT(5)	12	N
		X	X	16	SVT(5), SJT(3)	13	N
		X	-	16	SVT-R, SJT-R	13	N
		X	X	16	HPN	15	N
		X	-	16	HPN-R	15	N
		X	X	14	SJT(3)	15	N
5-15P	UE-322	X	X	18, 16, 14	SPT-2, SVT(5), SJT(3)	10, 13, 15	N
		X	-	18, 16, 14	SPT-2W, SPT-2-R, SVT-R, SJT-R	10, 13, 15	N
6-15P	UE-327	X	X	18, 16	SVT	10, 13	N
		X	-	18, 16	SVT-R	10, 13	N
		X	X	18, 16, 14	SJT, SJTW	10, 13, 15	N
		X	-	18, 16, 14	SJT-R, SJTW-R	10, 13, 15	N
*1-15P	UE-220	X	X	18	SPE-1, SPE-2, SPE-2-B, SVE-B, NISPE-1, NISPE-2	10	N
		X	X	16	SPE-2, SVE-B	13	N
5-15P	UE-320	X	X	18	SVE, SJE, SPE-2	10	N
		X	X	16	SJE, SPE-2	13	N
		X	X	14	SJE	15	N

*

Cord Group	Cord Type
1	SJ, SJW, SJO, SJOW, SJOO, SJOOW
2	SJE, SJEW, SJE0, SJEOW, SJE00, SJE0OW
3	SJT, SJTW, SJTO, SJTOW, SJTOO, SJTOOW
4	SVE, SVE0, SVE00
5	SVT, SVTO, SVTOO
6	S, SW, SO, SOW, SOO, SOOW
7	SE, SEW, SEO, SEOW, SEO0, SEOOW
8	ST, STW, STO, STOW, STOO, STOOW

ELECTRICAL RATING: (CONT'D)

Config	Cat. No.	USU	CNU	Cord AWG	Cord Type (Group)	Current (Amps)	Outdoor Use (Y/N)
5-15P	UE-322A	X	X	18, 16, 14	SJT, SJTW	10, 13, 15	N
		X		18, 16, 14	SJT-R, SJTW-R	10, 13, 15	N
		X	X	18, 16	SVT	10, 13	N
		X	-	18, 16	SVT-R	10, 13	N
		X	X	18, 16	HPN	10, 15	N
		X	-	18, 16	HPN-R	10, 15	N
		X	X	18, 16	SPT-2	10, 13	N
1-15P	UE-254	X	X	18, 16	SVT, SJT, SJTW, SPT-2	10, 13, 10, 13, 10, 13, 10, 13	N
		X	-	18, 16	SVT-R, SJT-R, SJTW-R, SPT-2-R	10, 13, 10, 13, 10, 13, 10, 13	N
		X	X	18, 16	HPN	10, 15	N
		X	-	18, 16	HPN-R	10, 15	N
1-15P	UE-255	X	X	27	TPT	0.5	N
1-15P	UE-251	X	X	18	Cat. No. UENISPT-2W	10	Y
5-15P	UE-374	X	X	18, 16	SVT, SVT-B	10, 13	N
		X	X	18, 16, 14	SJT, SJT-B	10, 13, 15	N
1-15P	UE-267	X	X	18, 16	SPT-2, NISPT-2	10, 13, 10, 13	N
		X	-	18, 16	SPT-2-R	10, 13	N
		X	X	18, 16	HPN	10, 15	N
		X	-	18, 16	HPN-R	10, 15	N
5-15P	UE-381B	X	X	18, 16, 14	SJT, SJTW	10, 13, 15	N

*

ELECTRICAL RATING: (CONT'D)

Config .	Cat. No.	USU	CNU	Cord AWG	Cord Type (Group)	Current (Amps)	Outdoor Use (Y/N)
1-15P	UE-299	X	X	18,16	SVT, SPT-2	10, 13	N
		X	-	18	SVT-R	10	N
		X	X	18	NISPT-2	10	N
		X	X	17	HPN	13	N
		X	X	16	HPN	15	N
L22- 30P	UE-6002	X	X	10	SJT, SOOW	25 3Ø Y	N
1-15P	UE-413	X	X	10	NISPT-2	10	N
1-15P	UE-410	X	X	16	HPN	15	N
		X	-	16	HPN-R	15	N

武汉超擎数智科技有限公司仅供武汉超擎数智科技有限公司存档使用，不作其他用途。



File E206144

Vol 1

Auth. Page 1

Issued: 2000-01-13

Revised: 2019-06-04

FOLLOW-UP SERVICE PROCEDURE
(TYPE L)

CORD SETS AND POWER-SUPPLY CORDS
(ELBZ,ELBZ7)

Manufacturer: SEE ADDENDUM FOR MANUFACTURER LOCATIONS

354263 (Party Site)
Applicant: UNIRISE ELECTRIC WIRE & CABLE CO LTD
(714326-001) LOONGYAN INDUSTRIAL AREA
HUMEN
DONGGUAN
GUANGDONG 523920 CHINA

354263 (Party Site)
Listee: SAME AS APPLICANT
(714326-001)

Use of the Mark

This Follow-Up Service Procedure authorizes the above Manufacturer(s) to use the marking specified by UL LLC, or any authorized licensee of UL LLC, including the UL Contracting Party, only on products when constructed, tested and found to be in compliance with the requirements of this Follow-Up Service Procedure and in accordance with the terms of the applicable service agreement with UL Contracting Party. The UL Contracting Party for Follow-Up Services is listed in the addendum to this Follow-Up Service Procedure ("UL Contracting Party"). UL Contracting Party and UL LLC are referred to jointly herein as "UL."

It is the responsibility of the Applicant, Manufacturer(s), and Listee/Classified Co. to make sure that only the products meeting the aforementioned requirements bear the authorized Marks of UL LLC, or any authorized licensee of UL LLC.

广东联升传导技术有限公司存档使用，不作其他用途。

Additional Responsibilities

Additional responsibilities, duties and requirements for the Applicant and Manufacturers are defined under Additional Resources at the following web-site: <http://www.ul.com/fus> . Manufacturers without Internet access may obtain the current version of these documents from their local UL customer service representative or UL field representative. For assistance, or to obtain a paper copy of these documents or the Follow-Up Service Terms referenced below, please contact UL's Customer Service at <http://www.ul.com/aboutul/locations/> , select a location and enter your request, or call the number listed for that location.

Acceptance of Follow-Up Services

The Applicant and the specified Manufacturer(s) and any Listee/Classified Co. in this Follow-Up Service Procedure must agree to receive Follow-Up Services from UL Contracting Party. If your applicable service agreement is a Global Services Agreement ("GSA"), the Applicant, the specified Manufacturer(s) and any Listee/Classified Co. will be bound to a Service Agreement for Follow-Up Services upon the earliest by any Subscriber of a) use of the prescribed UL Mark, b) acceptance of the factory inspection, or c) payment of the Follow-Up Service fees. The Service Agreement incorporates such GSA, this Follow-Up Service Procedure and the Follow-Up Service Terms which can be accessed by clicking the following link: <http://services.ul.com/fus-service-terms> . In all other events, Follow-Up Services will be governed by and incorporate the terms of your applicable service agreement and this Follow-Up Service Procedure.

Use and Ownership of the Follow-Up Service Procedure

This Follow-Up Service Procedure, and any subsequent revisions, is the property of UL and is not transferable. This Follow-Up Service Procedure contains confidential information for use only by the Applicant, the specified Manufacturer(s), and representatives of UL and is not to be used for any other purpose. It is provided to the Subscribers with the understanding that it is not to be copied, either wholly or in part unless specifically allowed, and that it will be returned to UL, upon request.

Definition of Terms

Capitalized terms used but not defined herein have the meanings set forth in the GSA and the applicable Service Terms or any other applicable UL service agreement.

No Third Party Liability

UL shall not incur any obligation or liability for any loss, expense or damages, including incidental, consequential or punitive damages arising out of or in connection with the use or reliance upon this Follow-Up Service Procedure to anyone other than the above Manufacturer(s) as provided in the agreement between UL LLC or an authorized licensee of UL LLC, including UL Contracting Party, and the Manufacturer(s).

Certification Body

UL LLC has signed below solely in its capacity as the certification body to indicate that this Follow-Up Service Procedure fulfills the requirements for certification documentation issued by the certification body.

Bruce A. Mahrenholz
Director
Conformity Assessment Programs (CPO)
UL LLC

DESCRIPTION

PRODUCT COVERED:

USU, CNU - Unlisted Component - Cord Connector, Cat. No. UE-357.

ELECTRICAL RATING:

Config. Rating	Cat. No.	USL	CNL	Cord AWG	Cord Type (Group)	Amps	Voltage
5-15R	UE-357	X	X	16	SVT, SVTO, SJT, SJTW, SJTO, SJTOW, SJTOO, SJTOOW, SJ, SJW, SJO, SJOW, SJOO, SJOOW	13	125 V
		X	X	14	SJT, SJTW, SJTO, SJTOW, SJTOO, SJTOOW, SJ, SJW, SJO, SJOW, SJOO, SJOOW	15	125 V
		X	X	12	SJT, SJTW, SJTO, SJTOW, SJTOO, SJTOOW, SJ, SJW, SJO, SJOW, SJOO, SJOOW	15	125 V

NOTE TO THE UL REPRESENTATIVE:

- "CN" indicates that the component has been evaluated to Canadian requirements and the component shall have a Canadian UL certification Mark (C-UL) or UL certification Mark and CSA certification Mark when the Applicant's basic product bearing a UL certification Mark.

DESCRIPTION

PRODUCT COVERED:

* USU, CNU - Unlisted Component - Connectors, Cat. Nos. UE-313, UE-223, UE-224, UE-323, UE-223A, UE-333, UE-313 S, UE-313A, UE-259, UE-223B, UE-262, UE-264, UE-867, UE-313R and UE-313Y, UE-388, UE-210, UE-2004, UE-2003 and UE-412.

ELECTRICAL RATING:

*Config Rating	Cat. No.	USU	CNU	Cord AWG	Cord Type (Group)	Amps	Voltage
C13	UE-313	X	X	18	SPT-2, SVT(5), SJT(3), HPN	10	125/250 V
		X	-	18	SPT-2-R	10	125/250 V
		X	X	16	SPT-2, SJT(3), SJOOW	13	125/250 V
		X	-	16	SPT-2-R	13	125/250 V
		X	X	16	HPN	15	125/250 V
		X	X	14	SJT(3), SJOOW	15	125/250 V
		X	X	12	SJOOW	15	125/250 V
Non- standar dized	UE-223	X	X	18	SPT-1	7	125 V
				18	SPT-2	7	125 V
				18	NISPT-2	7	125 V
				18	HPN	10	125 V
C7	UE-224	X	X	18	SPT-1	7	125 V
				18	SPT-2	7	125 V
				18	SPE-1	7/2.5	125/250 V
				18	SPE-2	7/2.5	125/250 V
				18	NISPT-2	7/2.5	125/250 V
				18	SJT	7/2.5	125/250 V
				18	SPT-2-B	7	125 V
C5	UE-323	X	X	18	SPT-2	7	125 V
				18	SVT(5)	7/2.5	125/250 V
				18	SVT-B	7/2.5	125/250 V
				18	SJT(3)	7/2.5	125/250 V
Non- standar dized	UE-223A	X	X	18	SPE-1	7	125 V
				18, 16	SPE-2	7	125 V
C7	UE-259	X	X	18	NISPT-1, NISPT-2, SPT-2, SPT-2-B	7/2.5	125/250V

Config. Rating	Cat. No.	USL	CNL	Cord AWG	Cord Type (Group)	Amps	Voltage
C19	UE-333	X	X	16	SJOOW	13	125/250V
				14	SJT, SJOOW	15	125/250 V
				12	SJT, SJOOW	20	125/250 V
C13	UE-313 S	X	X	18	SPT-2, SVT, SJT, HPN	10	125/250 V
		X	-	18	SPT-2-R, SVT-R, SJT-R, HPN-R	10	125/250 V
		X	X	16	SPT-2, SVT, SJT	13	125/250 V
		X	-	16	SPT-2-R, SVT-R, SJT-R	13	125/250 V
		X	X	16	HPN	15	125/250 V
		X	-	16	HPN-R	15	125/250 V
		X	X	14	SJT	15	125/250 V
		X	-	14	SJT-R	15	125/250 V
C15	UE-313A	X	X	18	SVT (5), SJT (3), HPN	10	125/250 V
		X	X	16	SVT (5), SJT (3),	13	125/250 V
		X	X	16	HPN	15	125/250 V
		X	X	14	SJT (3), HPN	15	125/250 V
Non- standard ized	UE-223B	X	X	18	SPT-2	7	125 V
		X	X	18	SPT-2	2.5	250 V
		X	-	18	SPT-2-R	7	125 V
		X	-	18	SPT-2-R	2.5	250 V
		X	X	16	SPT-2	7	125 V
		X	X	16	SPT-2	2.5	250 V
		X	-	16	SPT-2-R	7	125 V
		X	-	16	SPT-2-R	2.5	250 V
C7	UE-262	X	X	18	SVT	7	125 V
		X	X	18	SVT	2.5	250 V
C7	UE-264	X	X	18	SVT	7	125 V
		X	X	18	SVT	2.5	250 V
C7	UE-224A	X	X	18	SPE-2, SPE-2-B, NISPE-1, NISPE-2	7	125 V
		X	X	18	SPE-2, SPE-2-B, NISPE-1, NISPE-2	2.5	250 V
C7	UE-259B	X	X	18	SPE-2, SPE-2-B SPT-2, SPT-2-B	7	125 V
		X	X	18	SPE-2, SPE-2-B SPT-2, SPT-2-B	2.5	250 V

Config. Rating	Cat. No.	USL	CNL	Cord AWG	Cord Type (Group)	Amps	Voltage
C5	UE-323A	X	X	18	SVE	7	125 V
		X	X	18	SVE	2.5	250 V
Non- standard	UE-867	X	X	18	Cat. No. UENISPT-2W	7	125 V
C13	UE-313R	X	X	18	SVT, SJT	10	125/250 V
		X	X	16	SVT, SJT, SJOOW	13	125/250 V
		X	X	14	SJT, SJOOW	15	125/250 V
C13	UE-313Y	X	X	14	SJTW	15	125/250 V
C21	UE-388	X	X	16	SJT, SJOW, SJTW	13	125/250 V
				14	SJT, SJOW, SJTW	15	125/250 V
				12	SJT, SJOW, SJTW	20	125/250 V
C17	UE-210	X	X	18	SJT	10	125/250 V
C17	UE-2004	X	X	18	SVT, NISPT-2	10	125/250 V
		X	X	16	SVT, SJT	13	125/250 V
C9	UE-2003	X	X	18	SVT, NISPT-2	6	250 V
C7	UE-412	X	X	18	NISPT-2	2.5	250 V
		X	X	18	NISPT-2	7	125 V

Cord Group	Cord Type
1	SJ, SJW, SJO, SJOW, SJOO, SJOOW
2	SJE, SJEW, SJE0, SJEOW, SJE00, SJE0OW
3	SJT, SJTW, SJTO, SJTOW, SJTOO, SJTOOW
4	SVE, SVE0, SVE00
5	SVT, SVTO, SVTOO
6	S, SW, SO, SOW, SOO, SOOW
7	SE, SEW, SE0, SEOW, SE00, SE0OW
8	ST, STW, STO, STOW, STOO, ST0OW

NON-NEMA CONFIGURATION

Cat. No.	Config.	Cord AWG / No. of Conductors	Electrical Rating A/V	Sec.	Fig.	Services
UE-224A	IEC C7	18/2	7/125, 2.5/250	5	15	USU, CNU
UE-259B	IEC C7	18/2	7/125, 2.5/250	5	16	USU, CNU
UE-323A	IEC C5	18/3	7/125, 2.5/250	5	17	USU, CNU

USU - United States Standard, Unlisted Component.

CNU - Canadian National Standard, Unlisted Component.

武汉超擎数智科技有限公司仅供武汉超擎数智科技有限公司存档使用，不作其他用途。

DESCRIPTION

PRODUCT COVERED:

*USU, CNU - Unlisted Component - Appliance Inlet, Cats. No. UE-314, UE-334, UE-314 S, UE-379 and UE-380.

ELECTRICAL RATING:

Cat. No.	Config.	USL	CNL	Cord AWG	Cord Type (Group)	Amps	Voltage
UE-314	Sheet E	X	X	18	SPT-2, SVT, SJT, HPN	10	125/250 V
		X	-	18	SPT-2-R, SVT- R, SJT-R, HPN- R	10	125/250 V
		X	X	16	SPT-2, SVT, SJT, SJOOW	13	125/250 V
		X	-	16	SPT-2-R, SVT- R, SJT-R	13	125/250 V
		X	X	16	HPN	15	125/250 V
		X	-	16	HPN-R	15	125/250 V
		X	X	14	SJT, SJOOW	15	125/250 V
		X	-	14	SJT-R	15	125/250 V
		X	X	12	SJOOW	15	125/250 V
UE-334	Sheet I	X	X	16	SJOOW	13	125/250 V
		X	X	14	SJT, SJOOW	15	125/250 V
		X	X	12	SJT, SJOOW	20	125/250 V
UE-314 S	C14	X	X	18	SPT-2, SVT, SJT, HPN	10	125/250 V
		X	-	18	SPT-2-R, SVT- R, SJT-R, HPN- R	10	125/250 V
		X	X	16	SPT-2, SVT, SJT	13	125/250 V
		X	-	16	SPT-2-R, SVT- R, SJT-R	13	125/250 V
		X	X	16	HPN	15	125/250 V
		X	-	16	HPN-R	15	125/250 V
		X	X	14	SJT	15	125/250 V
		X	-	14	SJT-R	15	125/250 V
UE-379	Sheet I	X	X	12	SJTW	20	125/250 V
UE-380	Sheet I	X	X	12	SJTW	20	125/250 V